

27" COMBINATION MICROWAVE/WALL OVEN

JMW2427D – 27" x 43¾" x 25⅝"

PRODUCT DIMENSIONS

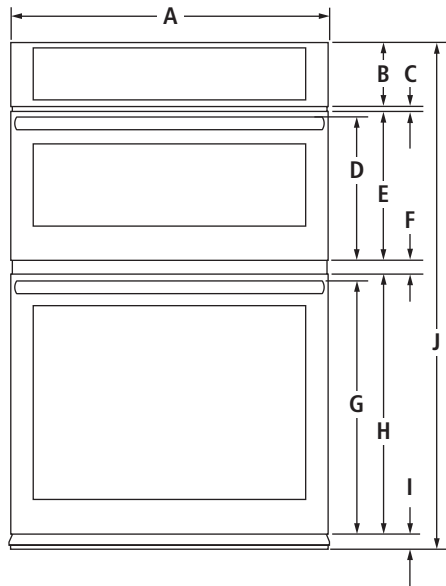

FRONT VIEW

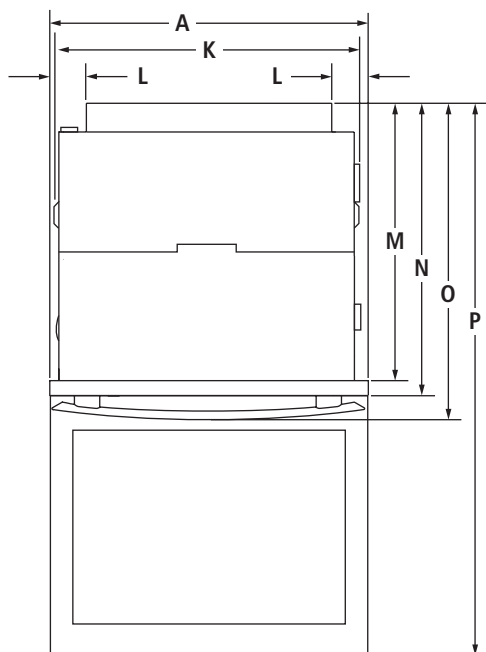

TOP VIEW

MODEL #		JMW2427D	
		in	cm
A	Overall width		
	Euro-Style Stainless	27	68.6
	Floating Glass	26 ¹⁵ / ₁₆	68.4
B	Height of control panel	5½	14
C	Space between control panel and door	½	1.2
D	Height to top of microwave oven handle	12 ³ / ₁₆	31.0
E	Height of microwave oven door	12 ¹¹ / ₁₆	32.3
F	Space between doors	1⅛	2.9
G	Height to top of oven handle	21 ⁷ / ₁₆	54.4
H	Height of oven door	22 ⁷ / ₈	56.2
I	Height of trim	1 ¹¹ / ₁₆	4.3
J	Overall height	43¾	111.1
K	Width of recessed oven	25 ⁷ / ₁₆	64.6
L	Width of conduit channel	3 ⁷ / ₁₆	8.7
M	Depth of recessed oven	23¼	59.0
N	Depth with doors	24 ³ / ₈	61.9
O	Depth with handles	25 ⁵ / ₁₆	64.3
P	Depth with door fully open	45 ³ / ₈	115.3

IMPORTANT: Dimensional specifications are provided for planning purposes only. Do not make any cutouts based on this information. Refer to the Installation Guide before selecting cabinetry, verifying electrical/gas connections, making cutouts or beginning installation. All Jenn-Air® appliances are appropriately UL, CUL or CSA approved.

27" COMBINATION MICROWAVE/WALL OVEN

JMW2427D – 27" x 43³/₄" x 25⁵/₁₆"

DIMENSIONS AS INSTALLED

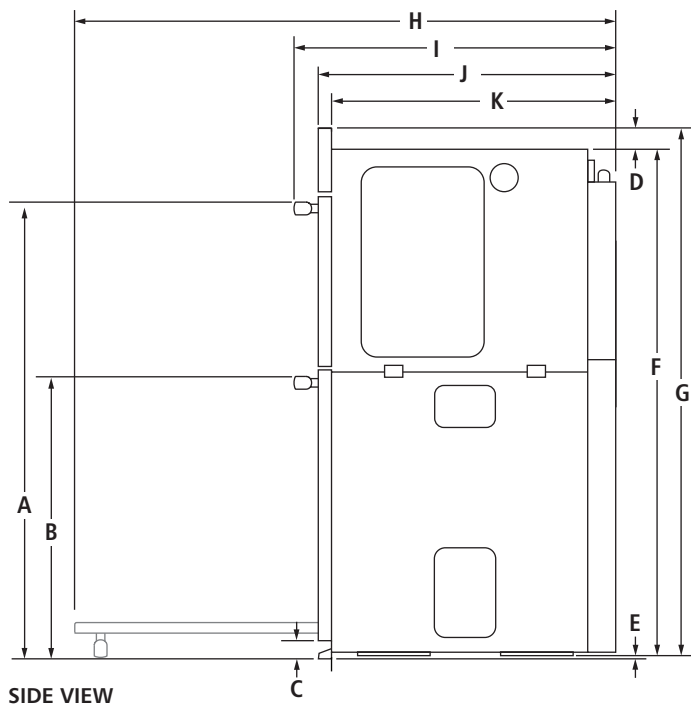

MODEL #		JMW2427D	
		in	cm
A	Height to top of upper handle	37 ³ / ₁₆	94.4
B	Height to top of lower handle	23 ⁵ / ₁₆	59.2
C	Height of trim extending below cutout	1 ¹ / ₁₆	4.3
D	Height from top of recessed oven to top of control panel	2 ¹⁵ / ₁₆	7.4
E	Height from bottom of recessed oven foot to bottom of oven vent	³ / ₁₆	0.5
D	Height of recessed oven	41	104.2
E	Height to top of control panel	43 ¹ / ₁₆	110.9
F	Depth with door fully open	45 ³ / ₈	115.3
G	Depth with handles	25 ⁵ / ₁₆	64.3
H	Depth with doors	24 ³ / ₈	61.9
I	Depth of recessed oven	23 ¹ / ₄	59.0

IMPORTANT: Dimensional specifications are provided for planning purposes only. Do not make any cutouts based on this information. Refer to the Installation Guide before selecting cabinetry, verifying electrical/gas connections, making cutouts or beginning installation. All Jenn-Air® appliances are appropriately UL, CUL or CSA approved.

27" COMBINATION MICROWAVE/WALL OVEN

JMW2427D – 27" x 43¾" x 25⅝"

OPENING/CLEARANCE DIMENSIONS

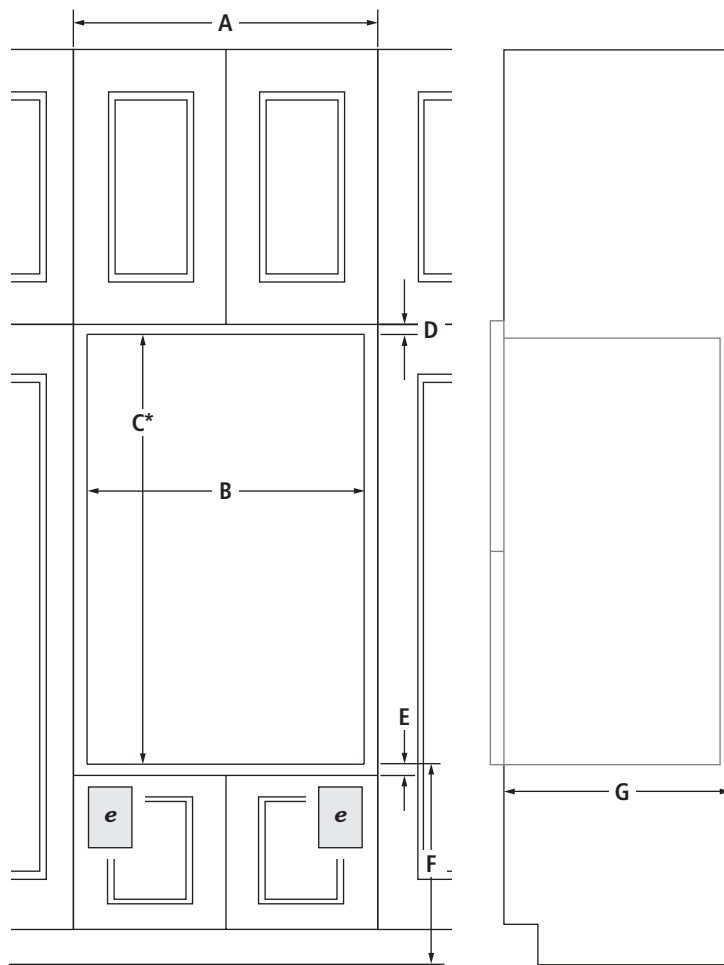

FRONT VIEW

SIDE VIEW

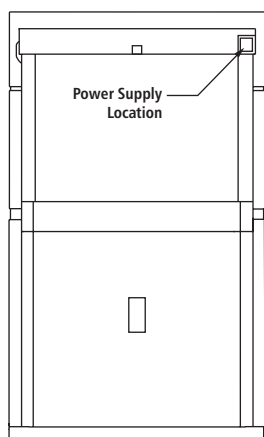

BACK VIEW

MODEL #		JMW2427D	
		in	cm
A	Width of cabinet (min.)	27	68.6
B	Width of cutout	25½	64.8
C*	Height of cutout (recommended)	41⅝	104.9
D	Top of cutout to bottom of upper cabinet door (min.)	2¼	5.7
E	Bottom of cutout to top of lower cabinet door (min.)	1½	3.8
F	Bottom of cutout to floor	4-19¼	10.2-48.9
G	Depth of cutout (min.)	24	61.0
e	Recommended junction box location		

* Will fit cutout height from 41" (104.1 cm) to 41½" (105.6 cm).

ELECTRICAL REQUIREMENTS

240 volt, 40-amp fused, grounded circuit is required. A dedicated circuit is required.

The length of conduit provided is for serviceability. Do not cut the conduit. The junction box should be located 3" (7.6 cm) maximum below the support surface. Drill a 1" (2.5 cm) minimum diameter hole in the right rear or left rear corner of the support surface for access to the junction box.

IMPORTANT: Dimensional specifications are provided for planning purposes only. Do not make any cutouts based on this information. Refer to the Installation Guide before selecting cabinetry, verifying electrical/gas connections, making cutouts or beginning installation. All Jenn-Air® appliances are appropriately UL, CUL or CSA approved.

27" COMBINATION MICROWAVE/WALL OVEN – FLUSH INSTALLATION

JMW2427D – 27" x 43¾" x 24⅜" (depth without handles)

OPENING/CLEARANCE DIMENSIONS

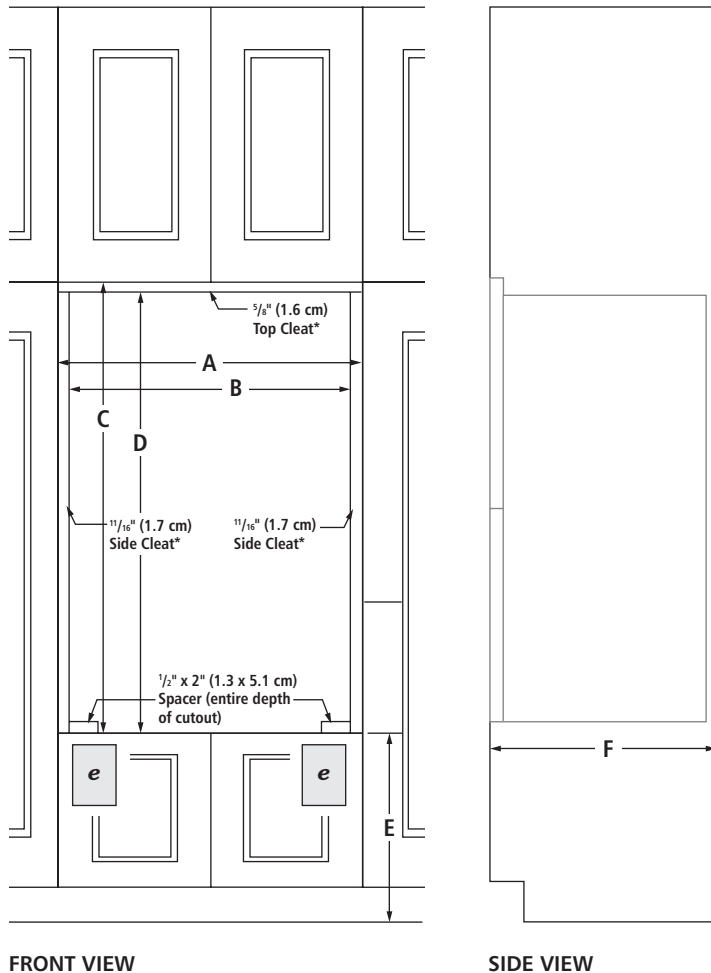

FRONT VIEW

SIDE VIEW

MODEL #		JMW2427D	
		in	cm
A	Width of flush inset cutout (min.)	27¼	69.2
B	Width of opening (min.)	25⅞	65.7
C	Height of flush inset cutout (min.)	44⅝	112.5
D	Height of opening (recommended)	43⅞	110.9
E	Bottom of cutout to floor	4⅝-19¼	11.7-48.9
F	Depth of cutout (min.)	25	63.5
e	Recommended junction box location		

ELECTRICAL REQUIREMENTS

240 volt, 40-amp fused, grounded circuit is required. A dedicated circuit is required.

The length of conduit provided is for serviceability. Do not cut the conduit. The junction box should be located 3" (7.6 cm) maximum below the support surface. Drill a 1" (2.5 cm) minimum diameter hole in the right rear or left rear corner of the support surface for access to the junction box.

FLUSH INSTALLATION REQUIREMENTS

A 25" (63.5 cm) minimum cutout depth is required.

These dimensions will result in a ¼" (0.6 cm) reveal on the top, a ¼" (0.6 cm) reveal on the sides and a ⅛" (0.3 cm) reveal on the bottom of the wall oven.

The front face of the cleats and spacers will be visible and should be treated as a finished surface.

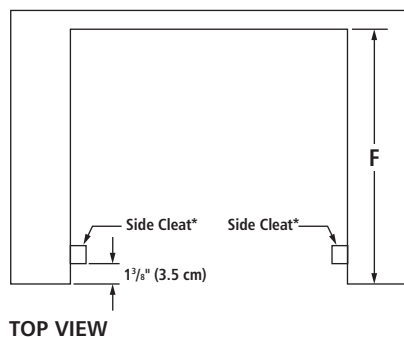

TOP VIEW

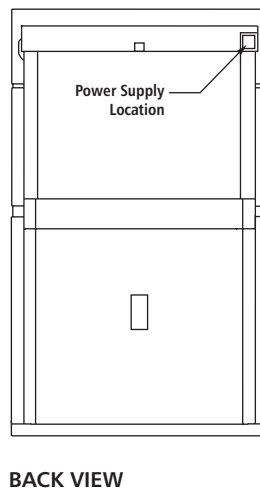

BACK VIEW

* Cleats and spacers must be recessed 1 7/8" (3.5 cm) from the front of the cabinet.

IMPORTANT: Dimensional specifications are provided for planning purposes only. Do not make any cutouts based on this information. Refer to the Installation Guide before selecting cabinetry, verifying electrical/gas connections, making cutouts or beginning installation. All Jenn-Air® appliances are appropriately UL, CUL or CSA approved.